



20 ALDERGROVE CLOSE

HALESWORTH, SUFFOLK, IP19 8TB



This two-bedroom, mid-terrace property offers off road parking, a single garage, a generous size sitting/dining room and two first floor bedrooms.

Stepping through the front door, you are welcomed into the entrance hallway. To the left is a WC that boasts a basin and toilet. To the right of the hallway is the kitchen which overlooks the front aspect of the property. The kitchen benefits from a good range of wall and base units as well as space for white goods. At the end of the hall is the sitting/dining room. This room has a door leading out to the garden and is a generous size room. There is a useful understairs cupboard for additional storage.

On the first floor you will find bedroom one. This is a good size double room with built in wardrobes and views overlooking the garden. Bedroom two is a small double/single room or could alternatively be used as a home office. The bathroom boasts a bath with shower over, basin and toilet. On the landing there is a useful airing cupboard.

Outside there is off road parking for two cars. The garden to the front and rear are very well maintained and there is a gate at the end of the garden that provides access to the path to the rear, giving easy access to the town. Overall, this home is very well presented and close to Halesworth town centre! Contact our office to arrange your viewing.

SERVICES - Mains water, drainage and electricity are connected. Heating is provided for by way of gas fired central heating. (Durrants has not tested any apparatus, equipment, fittings or services and so cannot verify they are in working order).

LOCAL AUTHORITY – East Suffolk – B

EPC – TBC

TENURE - Freehold

VIEWING - Strictly by appointment with the agent's Halesworth office. Please call 01986 872 553. **DURRANTS BUILDING CONSULTANCY** - Our Building Consultancy Team will be happy to provide advice to prospective buyers on planning applications, architectural design, building regulations, and project management - please contact the team directly.





FLOOR PLAN

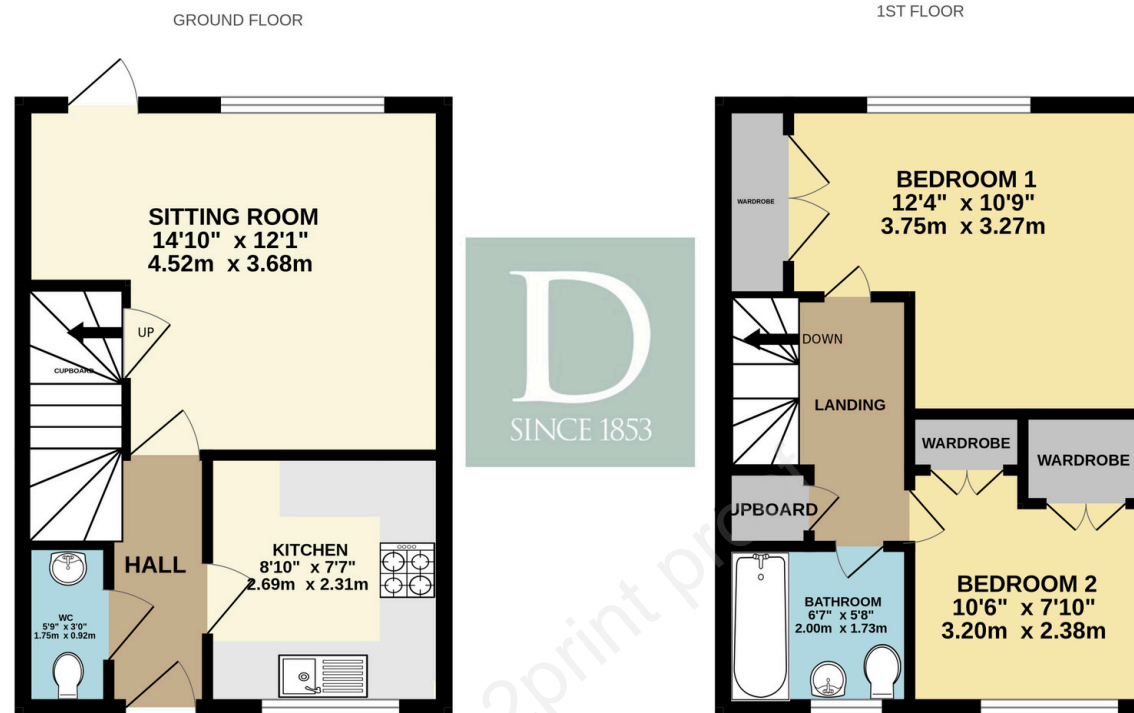

Whilst every attempt has been made to ensure the accuracy of the floorplan contained here, measurements of doors, windows, rooms and any other items are approximate and no responsibility is taken for any error, omission or mis-statement. This plan is for illustrative purposes only and should be used as such by any prospective purchaser. The services, systems and appliances shown have not been tested and no guarantee as to their operability or efficiency can be given.
Made with Metropix ©2025

Residential Agricultural Commercial On Site Auctions Property Management Building Consultancy Auction Rooms Holiday Cottages

IMPORTANT NOTICE

Durrants and their clients give notice that:

- 1.They are not authorised to make or give any representations or warranties in relation to the property either here or elsewhere, either on their own behalf or on behalf of their client or otherwise. They assume no responsibility for any statement that may be made in these particulars. These particulars do not form part of any offer or contract and must not be relied upon as statements or representations of fact.
- 2.Any areas, measurements or distances are approximate. The text, photographs and plans are for guidance only and are not necessarily comprehensive. It should not be assumed that the property has all necessary planning, building regulation or other consents. Durrants have not tested any services, equipment or facilities. Purchasers must satisfy themselves by inspection or otherwise.

CONTACT US

Durrants, 12 Thoroughfare,
Halesworth, Suffolk, IP19 8AH

Tel : **01986 872553**

Email : **halesworth@durrants.com**